

Extending the pedestrian area in Peascod Street



A number of local businesses and shoppers in Windsor have asked the Royal Borough to consider re-routing buses away from the current stop in Peascod Street so that this part of the town centre can be traffic-free during shopping hours.

Those businesses and local residents want to close Peascod Street and Oxford Road East to all traffic, including buses, during main shop opening hours.

The proposal would mean having to relocate the bus stop from Peascod Street to nearby Charles Street, which would enable a more pedestrian friendly area to be created.

The initiative, backed by Windsor Chamber of Commerce, would maintain access for emergency vehicles but would severely limit access by other vehicles. Deliveries to shops would be allowed but only where there was no other alternative and outside the main shopping hours. The

rising bollard would remain in place.

A new bus stop would be created in Charles Street by building a new layby between the main road and the access road. The stop would include bus shelters, comfortable seating, real-time bus information and sign-posting to Peascod Street. It would also allow for additional buses supporting the council's edge-of-town parking at Windsor Racecourse, Centrica and Home Park.

There would be a loss of some residents' parking spaces in Charles Street but residents directly affected would be consulted on suitable alternatives.

The lower part of Peascod Street already has restricted traffic access, thanks to the recently-installed rising bollard. However, supporters of the full pedestrianisation scheme say it would create a seamless traffic-free link with the top end of Peascod Street – already fully



pedestrianised – and provide a safe environment for residents and visitors to enjoy the shops, cafés and restaurants in this part of the town. The existing steps to Waitrose and the footpath provide access to the shops in King Edward Court and Peascod Street from the proposed new bus stop.

So before taking any decision, the council wants to hear YOUR views.

Cllr Colin Rayner, lead member for highways and streetcare, said: "This proposal to support pedestrianisation

has provoked a great deal of debate in Windsor. It is vital that we get as much local input as possible before saying yes or no. That's why we are launching a widespread consultation so businesses, residents, bus users and visitors can put forward their views.

"Once we have all the views we will then take further decisions based on the outcome of the consultation."

Your views are vital to help the council decide. You can take part in the consultation by:

- **Completing the questionnaire**
- **And**

sending it to Peascod Street Consultation, FREEPOST RLYH-SHYR-JUXJ, Royal Borough of Windsor and Maidenhead, Town Hall, St Ives Road, Maidenhead SL6 1RF.

● **Taking part online at www.rbwm.gov.uk**

The council has also commissioned direct consultation with businesses, bus users and pedestrians in this part of Peascod Street.

The closing date for responses is **Friday 30 November**. Afterwards all views will be analysed and a report will be prepared to help the council decide on the way forward.

HAVE YOUR SAY

- Do you agree with the relocation of the bus stop from Peascod Street to Charles Street? **YES** **NO**
- Do you support the potential for additional pedestrianisation in Peascod Street? **YES** **NO**
- Do you think it will help local businesses and provide a better, safer environment for shoppers and visitors? Will it help foster a cosmopolitan café culture that will draw more people to this part of the town? **YES** **NO**
- Or do you think the current traffic restrictions using the new rising bollard are enough and that moving the bus stop to Charles Street would cause serious inconvenience to local bus passengers? **YES** **NO**

ADDITIONAL COMMENTS: Do you have any other comments or suggestions? (Please use additional sheets if necessary).

.....

You do not need to provide your name and address but your postcode will help with our response analysis.

POSTCODE:

Planning

Badnell's Pit decontamination

Council's pledge on residents' safety

Residents' safety is top of the Royal Borough's priority list both before and after developer Shanly Homes starts its decontamination of Badnell's Pit early next year.

Cllr Alison Knight, lead member for planning, development and property, said: "The council is adamant that the safety of local residents is paramount and we are encouraged that the developer has recently re-confirmed it is fully committed to all the safety measures agreed when the Secretary of State granted planning permission.

"However, we will be monitoring this scheme every inch of the way."

A residents' monitoring group has now been set up to work closely with the council and an independent

specialist during the works.

Residents and councillors also attended a Shanly pre-start public meeting in the Thames Hotel last month to learn more about this highly sensitive and controversial scheme and the developer has started to send out regular residents' newsletters.

Cllr Knight said: "As well as the overall safety aspects of the work, there are key areas of concern to residents and the council, including noise and disturbance.

"The council is also in discussions with Shanly Homes about the need to install a temporary haul route for site traffic across Town Moor to minimise disruption to the community.

"We believe strongly that this route is a necessity and

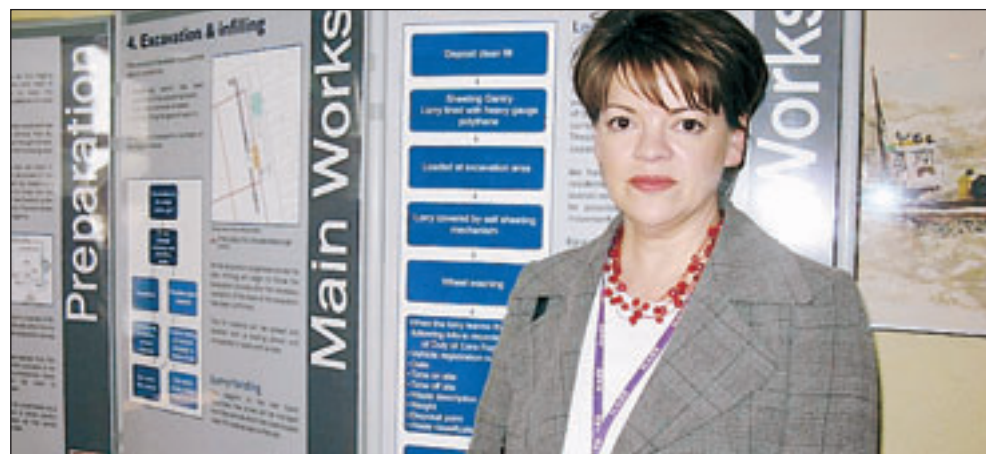

WATCHFUL EYE: Cllr Alison Knight, lead member for planning, development and property, at the Shanly Homes pre-start meeting in September.

we will be maintaining this position on behalf of residents."

In the run-up to the start of this complex scheme, council officers from a wide range of specialisms have been meeting regularly to co-ordinate preparations – looking at key issues such as noise, pollution, vibration, town planning and highway engineering.

The residents' monitoring

group will work with the council to:

- help appoint an independent consultant to monitor the ongoing results of decontamination tests undertaken by the developer
- monitor and review the developer's test results
- keep the local community informed
- help ensure that disturbance is kept to a minimum
- monitor and review safety

arrangements.

Residents who would like to receive all council updates on the decontamination scheme should send their details to badnells@rbwm.gov.uk

The council also has special web pages at www.rbwm.gov.uk and an information line on 01628 683810 to ensure information is readily available to local people.

Badnell's 'not the same as Corby'

Following the recent high-profile court case which found that Corby Council was negligent when decontaminating a steel works about 30 years ago, the Royal Borough is assuring residents that the two cases are different for a range of reasons including:

Badnell's work will be undertaken by a specialist experienced contractor on behalf of the Shanly Group.

As part of the planning permission the developer must deliver a range of measures to protect residents.

The council will have an environmental protection officer based at the site throughout the works.

The Royal Borough has taken legal advice and has been reassured that issues involved in the two sites are not directly comparable and that there is no legal basis for stopping the remediation.

Thames Street, Windsor - traffic improvements

Royal Borough residents, local businesses, Windsor Castle and motorists are to be asked for their views on possible changes to the traffic flow in the area of Thames Street in front of Windsor Theatre Royal. This is because of traffic congestion in that part of Windsor.

Two proposals are under consideration in response to pleas from local businesses and are part of the council's ongoing commitment to freeing up congestion in the roads around Windsor. The present restrictions mean that vehicles approaching the town centre from Datchet are banned from travelling uphill on Thames Street past the castle and must continue along Barry Avenue and into the surrounding roads, adding to local congestion.

The main proposal

would be to create one-way traffic movement around the front and back of the Theatre Royal (as shown on the plan on the right).

The alternative is to reintroduce two-way traffic for cars in Thames Street in front of the theatre and reverse the traffic direction on River Street for cars only (as shown below).

Cllr Colin Rayner, lead member for highways and street-care, said: "Local businesses and the Chamber of Commerce believe that by improving the movement of traffic in this area we can alleviate some of the

Please tell us what you think

traffic jams around the outer town centre. This would also encourage more people into the town centre itself to enjoy the shops, cafes and restaurants.

"We do have concerns about the speed of cars going up Thames Street towards the castle.

"Any scheme will be designed sympathetically to take into account the needs of the many pedestrians who enjoy the town centre.

There will be no changes to any of the bus routes or stops.

"We want to hear the views of as many people as possible who live or work in the area to enable us to make a decision based on what people really want.

"We are committed to easing congestion and supporting the town centre and are determined to work towards a practical solution – so please take the time to tell us what you think.

"No decisions will be made until full consultation has taken place and the traffic model has been run through our computer systems.

"We need to know what people think before we go to the next stage and carry out a further full public consultation with various options and costs."

You can take part in the consultation by answering the questions below.

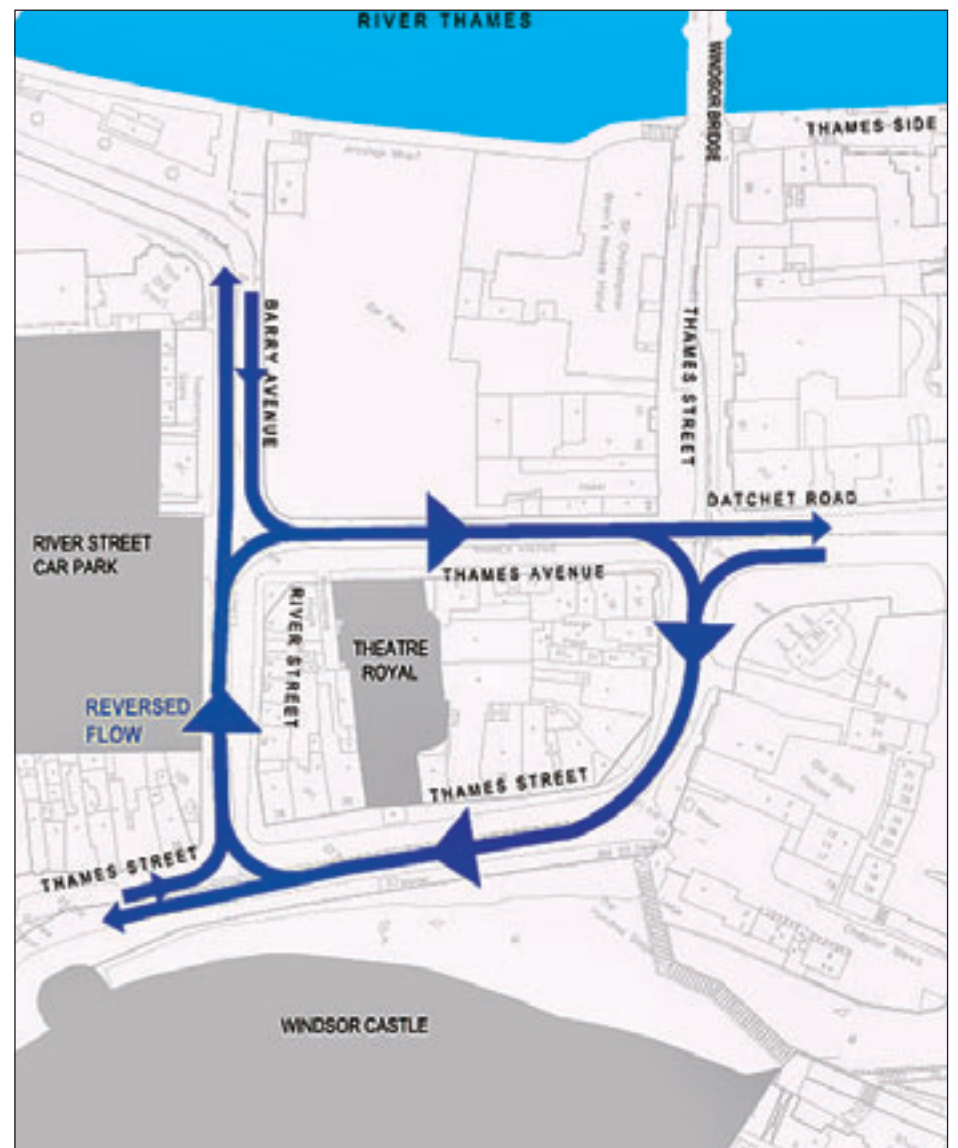

MAIN PROPOSAL (ONE-WAY)

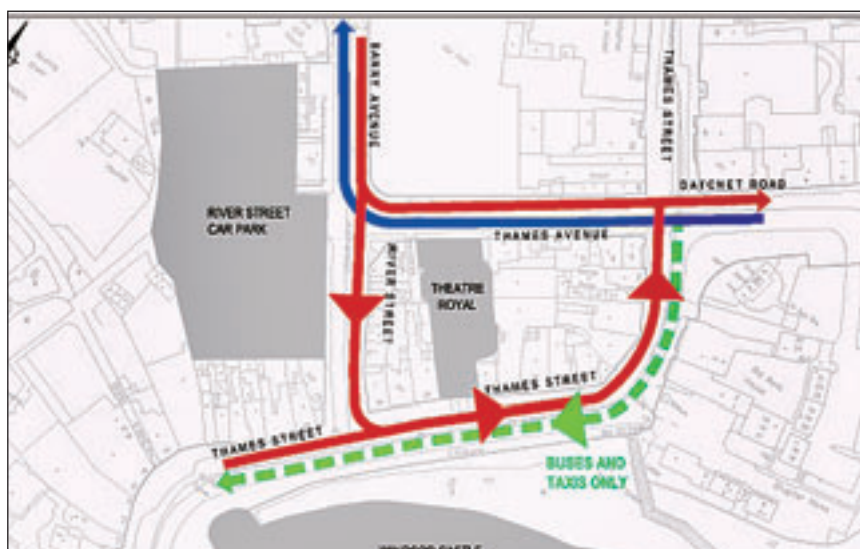

EXISTING TRAFFIC FLOW

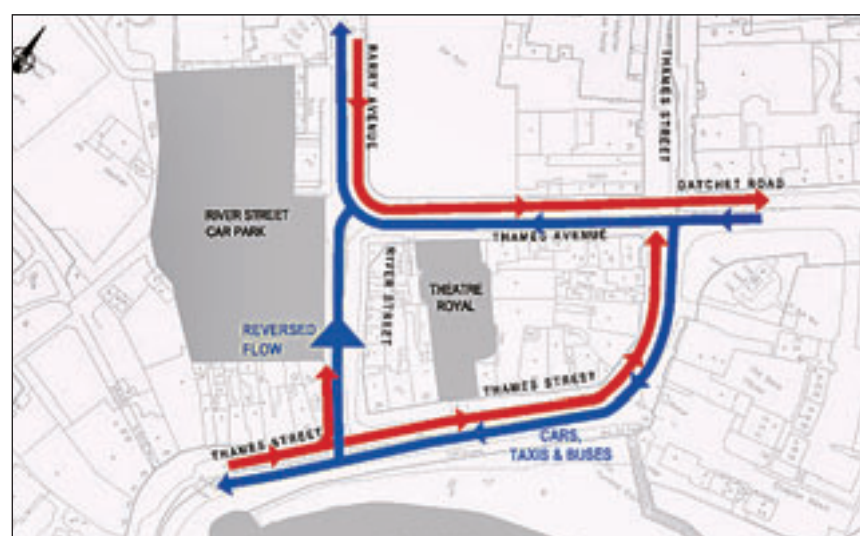

ALTERNATIVE PROPOSAL (TWO-WAY)

'We are committed to easing congestion and achieving a practical solution.' Cllr Colin Rayner

HAVE YOUR SAY

● Do you agree that the council needs to take measures to improve traffic movement in Thames Street in front of Windsor Theatre Royal? YES NO

● Do you support the council's main proposal? YES NO

● Do you support the council's alternative proposal? YES NO

● Which of the two proposals do you think would have the greatest benefit in reducing congestion and supporting the town centre? MAIN PROPOSAL ALTERNATIVE PROPOSAL

ADDITIONAL COMMENTS: Do you have any other comments or suggestions to alleviate the congestion problem? (Please use additional sheets if necessary).

.....

.....

.....

You do not need to provide your name and address but your postcode will help with our response analysis.

POSTCODE:

Please send your responses to Thames Street Consultation, FREEPOST RLYH-SHYR-JUXJ, Royal Borough of Windsor and Maidenhead, Town Hall, St Ives Road, Maidenhead, Berkshire SL6 1RF. Take part online at www.rbwm.gov.uk or write to the Traffic and Road Safety team at the address above. Closing date: **Friday 30 November.**

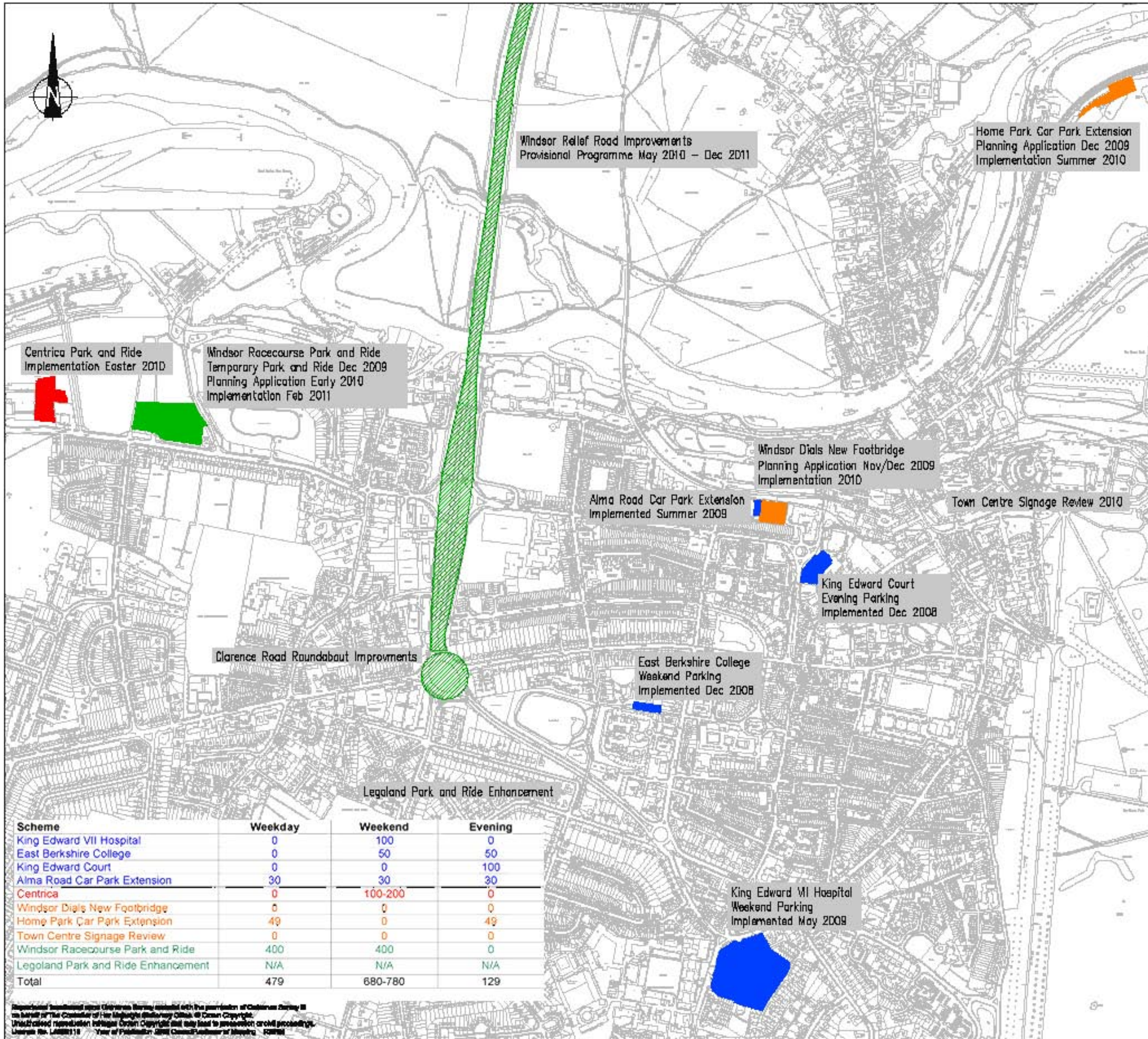

Note: 200-300 new spaces implemented on-street

Key:

- Implemented Schemes
- Short Term Options
- Medium Term Options
- Long Term Options

Scheme	Weekday	Weekend	Evening
King Edward VII Hospital	0	100	0
East Berkshire College	0	50	50
King Edward Court	0	0	100
Alma Road Car Park Extension	30	30	30
Centrica	0	100-200	0
Windsor Dials New Footbridge	0	0	0
Home Park Car Park Extension	49	0	49
Town Centre Signage Review	0	0	0
Windsor Racecourse Park and Ride	400	400	0
Legoland Park and Ride Enhancement	N/A	N/A	N/A
Total	479	680-780	129

Name	Reviser	Drawn	Date	Checked

WARNING NOTE: Do not scale from this drawing. If in doubt, ask.
UTILITIES NOTE: The position of any existing public or private services, utility services, plant or apparatus shown on this drawing is believed to be correct, but no warranty is made in respect of or liability for errors or omissions may also be present but not shown. The Contractor is therefore advised to ascertain the exact location of any services in the presence of any existing services, services, plant or apparatus may affect the operations.

Drawing Issue Status: **DRAFT**

WINDSOR PARKING STRATEGY
SCHEME OVERVIEW

Client: 	
Date of last issue: 28.11.2009	Drawn by: GFF
AD made: NTS	Checked by: AF
Drawing Number: 20812/001/011	Revised:



Office throughout the UK, services in Europe, Africa and Asia
www.peterbrett.com
 Peter Brett Associates LLP
 2000000
 Tel: 0125 880 0781 Fax: 0125 880 1480

Reproduction prohibited except otherwise stated with the permission of Cabinet Services III on behalf of the Controller of Her Majesty's Stationery Office. © Crown Copyright. Unauthorised reproduction infringes Crown Copyright and may lead to prosecution and/or proceedings for damages. Licence No. L4000118 Year of Publication: 2009 Council/Author of Mapping: 200909